

# Compact fuse-holders CC8, CC10

## FUSE HOLDERS, FUSE BASES AND SUPPORTS

### IEC CYLINDRICAL FUSE HOLDERS



The innovative and comprehensive range of Mersen fuse-holders. CC fuse-holders are available in 1, 2, 3 poles, in IEC version in a very special compact design. Multi-pole units can also be field assembled by ordering pin-ties assembly kit. CC range is made of tough and durable thermoplastic material.

### TECHNICAL DATA OVERVIEW

Voltage Range AC	400 ... 660 VAC
Ampere Range (A)	25 ... 32 A
Mounting	Installation on symmetrical DIN rails with adapter Screw-on mounting in back of panel
Number of poles	1-pole

### FEATURES & BENEFITS

- Very compact design for small space applications
- Panel mounted

### APPLICATIONS

- All circuits up to 660V for protection of motors, transformers, low voltage distribution, control circuits
- Non-load operation
- Special applications where small room is available like street lighting connection boxes

### STANDARDS

- IEC 60269-2
- RoHS Compliant



# Compact fuse-holders CC8, CC10

## PRODUCT RANGE



CC81

### ModuloStar® CC8 for fuse-links 8x31mm, 25A, 400V

Catalog number	Item number	Number of poles/phases	Package	Weight
CC81	E215146	1	12	48 g



CC101

### ModuloStar® CC10 for fuse-links 10x38mm, 32A, 660V

Catalog number	Item number	Number of poles/phases	Package	Weight
CC101	S211570	1	12	50 g

## TECHNICAL DATA

	CC8	CC10
Size	8x31	10x38
Number of poles/phases	1	1
Utilization category to IEC/EN 60947-3 $U_e = AC 400 V$ ; $I_e = 25 A$	-	AC 20 B
Rated voltage $U_n$	400 V	660 V
Rated current	25 A	32 A
Wiring cross sections	1x10mm <sup>2</sup>	1x10mm <sup>2</sup>
Utilization category to IEC/EN 60947-3 $U_e = AC 400 V$ ; $I_e = 25 A$	-	AC 20 B

# Compact fuse-holders CC8, CC10

## DIMENSIONS

### Modular fuse-holders for cylindrical fuse-links 8x32 and 10x38

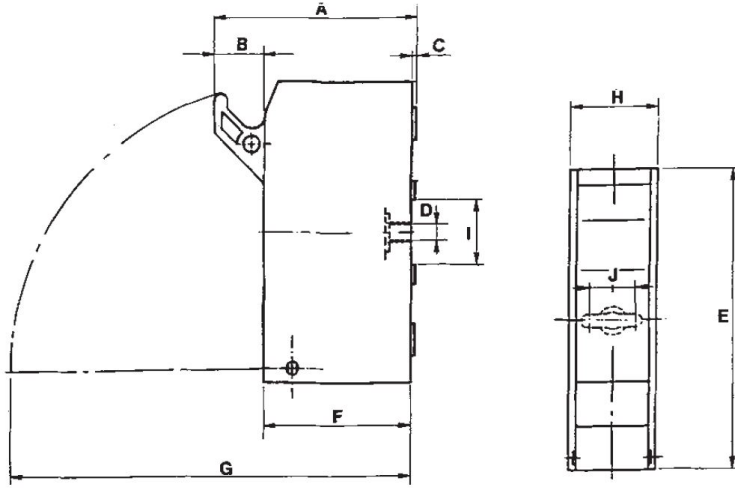

CC8/10	
A	40
B	9
C	2
D	5,5
E	77,5
F	33
G	100
H	17,5
I	46
J	-
K	77,5
L	60
M	42,5
N	-

Dimensions in mm