

MONITORING MERSEN'S DUSTCOLLECTOR

ZOOM

MAKING THE MOST
OF MERSEN'S
DUSTCOLLECTOR



Smart M3

MONITOR THE PERFORMANCE OF MERSEN'S DUSTCOLLECTOR SYSTEM

= Input / Output interfaces
for interaction between machine and operator

Thresholds can be set to trigger alarms.

Information is transmitted by dry contact (max 6A / 230VUC)
and/or Ethernet network depending on the option you choose.

The electrical cabinet can be installed on the vacuum unit or
close to the generator.



For your peace of mind, Mersen's
specialists can take care of the mounting
operations!

MERSEN PROPERTY



WE OFFER 3 LEVELS OF
MONITORING SYSTEMS TO
MEET YOUR REQUIREMENTS *

BASIC M1

- ✓ Filtration state (filter clogging)
- ✓ Vacuum fault
- ✓ Components fitted into an electrical cabinet

OPTIMUM M2

= "BASIC M1",
PLUS OTHER OPTIONS:

- ✓ Brush wear
- ✓ Stop & Go operation (Eco mode)
- ✓ Others, please inquire

SMART M3

= "OPTIMUM M2",
PLUS OTHER OPTIONS:

- ✓ Slip ring compartment temperature
- ✓ Visual alarm
- ✓ Touch screen display
- ✓ Possibility of Ethernet connection (remote display)
- ✓ Operation statistics, alarm history
- ✓ Others, please inquire

* Above features are only samples of the
possibilities of our monitoring systems.

Please inquire for more info:
info.ptt@mersen.com

BASIC

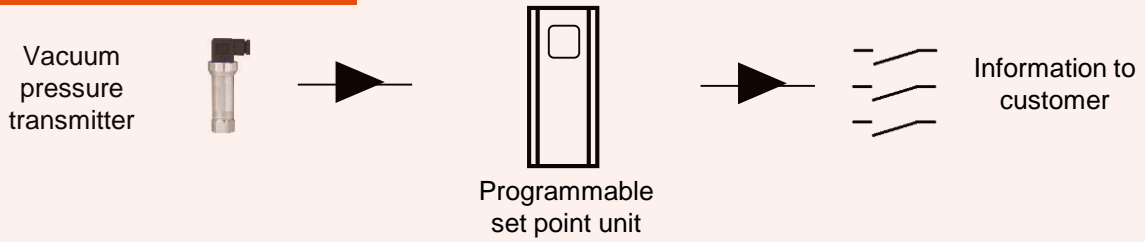

OPTIMUM

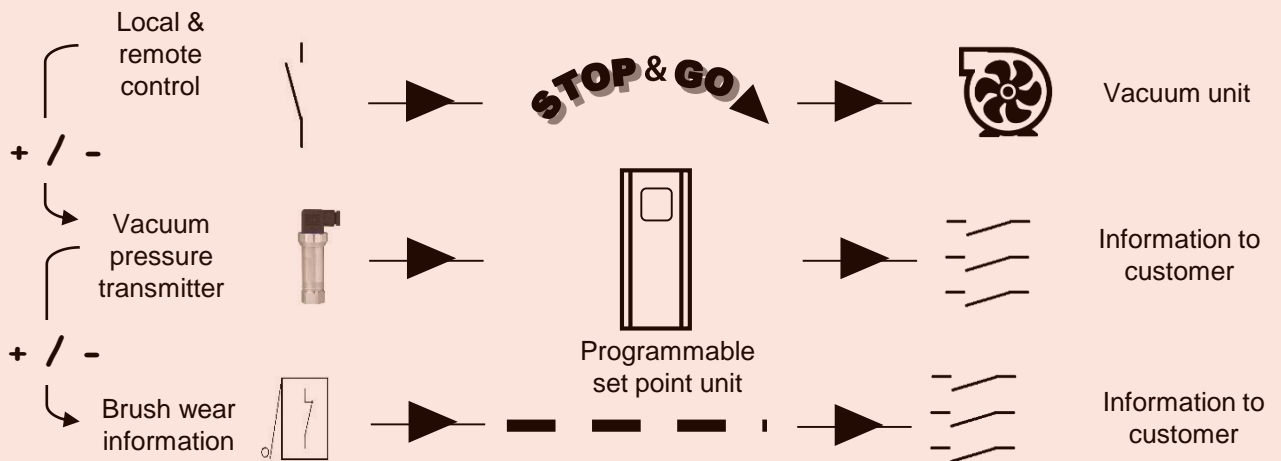

SMART

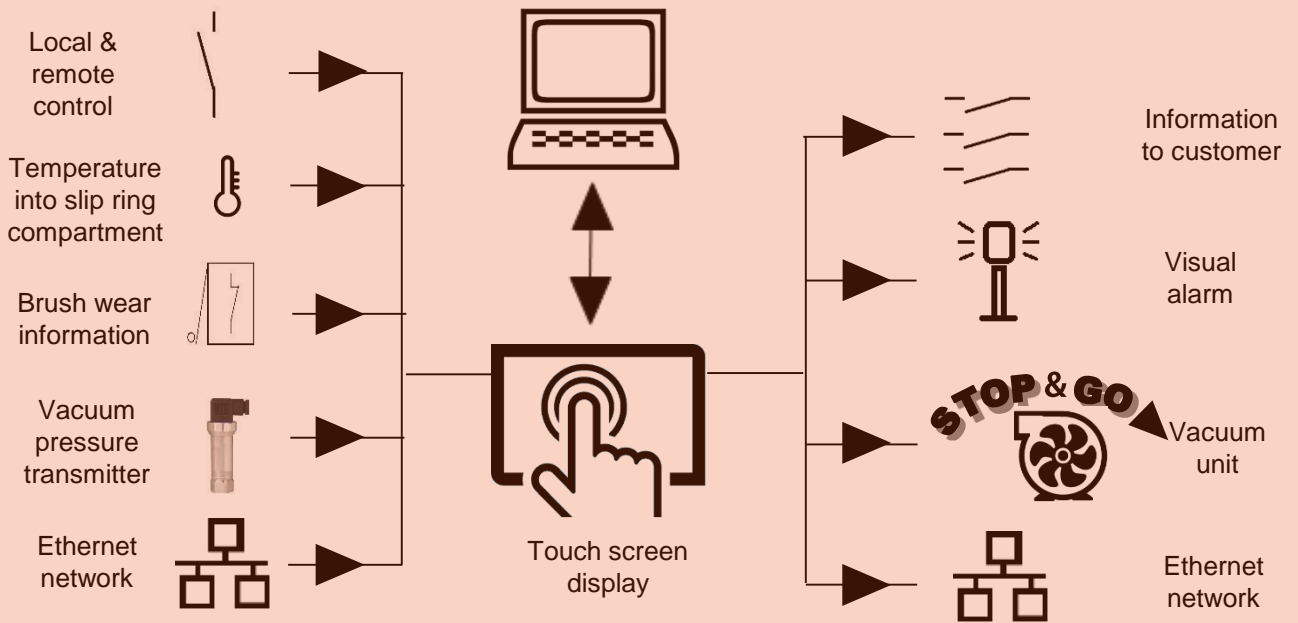

PTT-MDC-monitoring-EN-1908

MERSEN PROPERTY

Contact: info.ptt@mersen.com